

## FRONT WHEEL/SUSPENSION/STEERING

### INSTALLATION

Install the side collars [1] to the front wheel.

Apply a thin coat of grease to the front axle sliding surface.

Install the front wheel between the forks.

*Align the surfaces of the axle and right fork [3] as shown.*

Install the front axle [2] from right side.

Tighten the right front axle holder pinch bolts [4] to the specified torque.

**TORQUE: 22 N·m (2.2 kgf·m, 16 lbf·ft)**

Install and tighten the axle nut [5] to the specified torque.

**TORQUE: 60 N·m (6.1 kgf·m, 44 lbf·ft)**

Loosen the right front axle holder pinch bolts.

Tighten the left front axle holder pinch bolts [6] to the specified torque.

**TORQUE: 22 N·m (2.2 kgf·m, 16 lbf·ft)**

Install the front brake calipers (page 19-18).

With the front brake applied, pump the forks up and down several times to seat the axle and check brake operation.

Tighten the right front axle holder pinch bolts to the specified torque.

**TORQUE: 22 N·m (2.2 kgf·m, 16 lbf·ft)**

ED model: Install the axle cap [7].

Check the clearance gap between the front wheel speed sensor bracket and pulser ring (page 20-21).

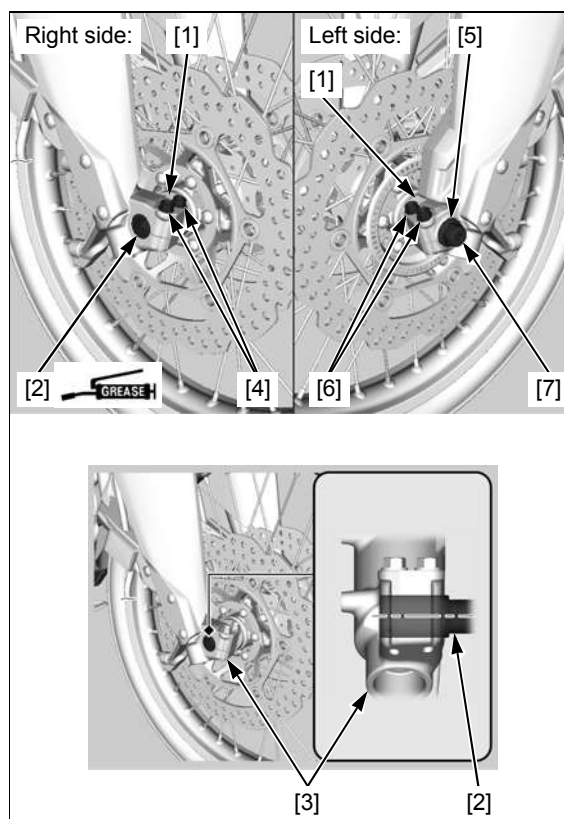

## FORK

### REMOVAL

Remove the following:

- Front fender (page 2-9)
- Front wheel (page 17-10)
- Front speed sensor (CRF1000A/D) (page 20-20)

Loosen the top bridge pinch bolts [1].

*Be careful not to damage the fork bolt when loosening it.*

If the fork will be disassembled, loosen the fork bolts [2] at this point, but do not remove yet.

Loosen the fork bottom bridge pinch bolts [3] by holding the forks then remove it.

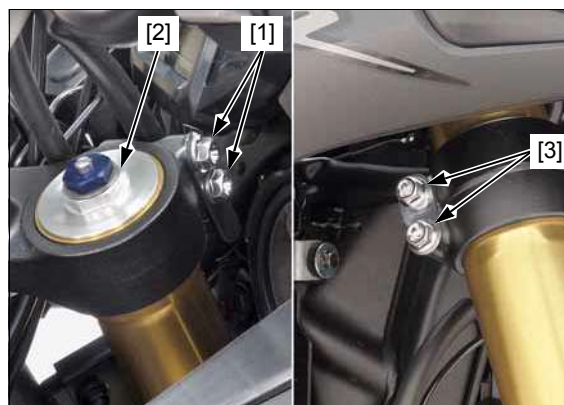

When disassembling the fork, turn the pre-load adjuster [1] and rebound adjuster [2] counterclockwise to the softest position (be sure to record the number of turns from the starting position).



### DISASSEMBLY

*Be careful not to damage the fork bolt when removing it.*

Remove the fork bolt [1].



Push the outer pipe [1] slowly down, and gently seat the dust seal [2] onto the axle holder [3].

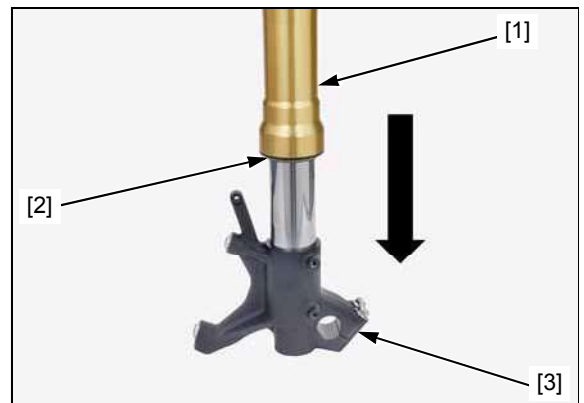

Attach the special tool to the spring collar holes [1].

**TOOL:**

**Spring collar holder [2]**

**070MF-MBZC110**

Compress the spring collar [3] with the spring collar holder.

Insert the special tool between the lock nut [4] and spring collar.

**TOOL:**

**Stopper plate [5]**

**070MF-MBZC130**



## FRONT WHEEL/SUSPENSION/STEERING

*Be careful not to damage the fork bolt when loosening it.* Loosen the fork bolt [1] while holding the lock nut [2].

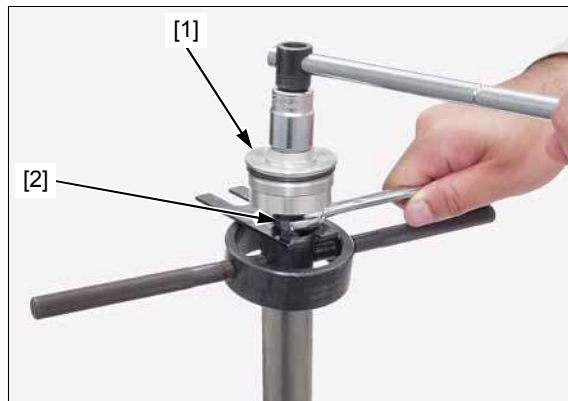

Remove the following:

- Fork bolt assembly [1]
- O-ring [2]
- Spring seat stopper [3]

Remove the stopper plate [4] and spring collar holder [5].

Remove the spring collar [6].



Pour out the fork fluid by pumping the outer pipe [1] several times.

Pour out the fork fluid from the fork damper by pumping the damper rod [2] several times.

Remove the fork spring [3].

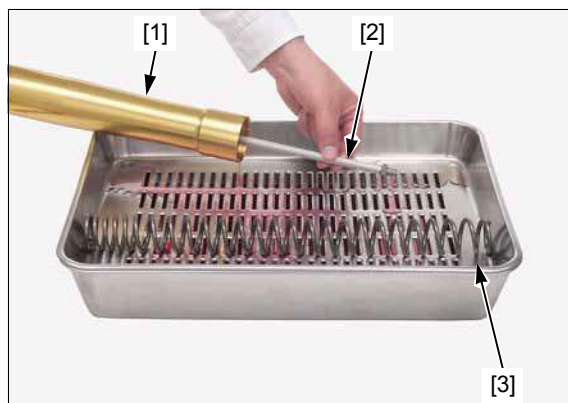

Hold the axle holder in a vise with soft jaws or a shop towel.

Remove the fork center bolt [1] and sealing washer [2].

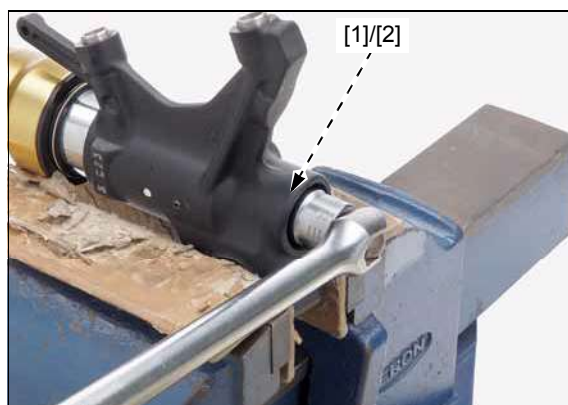

Remove the fork damper assembly [1] and centering plate [2].

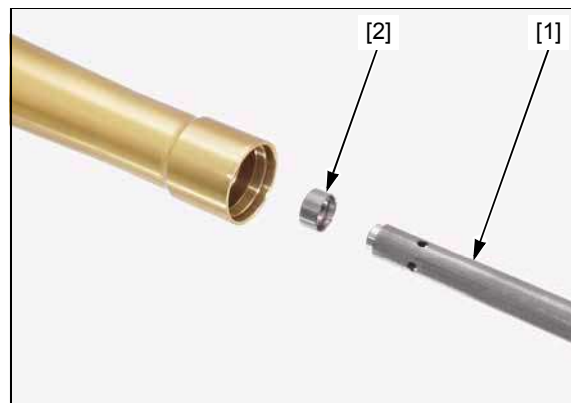

Remove the dust seal [1].

*Do not scratch the fork pipe sliding surface.*

Remove the oil seal stopper ring [2].



Pull the slide pipe assembly [1] out until you feel resistance from the slider bushing. Then move it in and out, tapping the bushing lightly until the outer pipe [2] separates from the slide pipe assembly. The guide bushing will be forced out by the slider bushing.

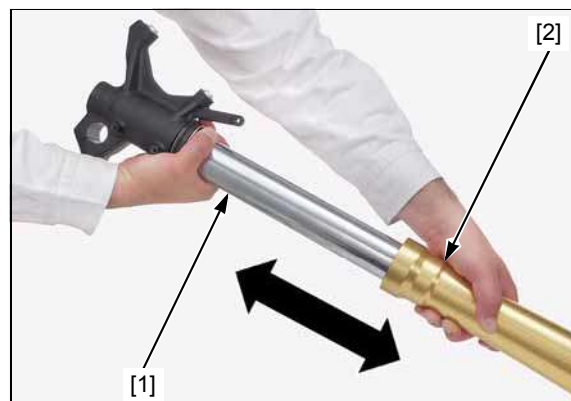

Remove the following:

- Slider bushing [1]
- Guide bushing [2]
- Back-up ring [3]
- Oil seal [4]
- Stopper ring [5]
- Dust seal [6]

NOTE:

- Do not remove the slider bushing unless it is necessary to replace with a new one.

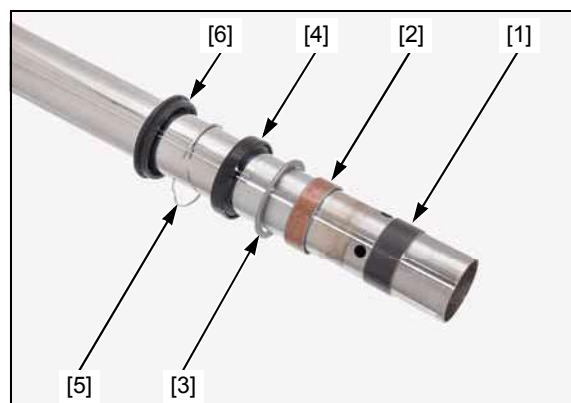

## FRONT WHEEL/SUSPENSION/STEERING

### INSPECTION

Inspect the following parts for damage, abnormal wear, deformation, looseness or bend.

- Fork bolt assembly
- Outer pipe/slide pipe assembly
- Fork dumper
- Spring seat stopper
- Spring collar
- Fork spring
- Guide bushing
- Slider bushing
- Back-up ring

Measure each part according to FRONT WHEEL/SUSPENSION/STEERING SPECIFICATIONS

(page 1-10).

Replace any part if it is out of service limit.

### ASSEMBLY

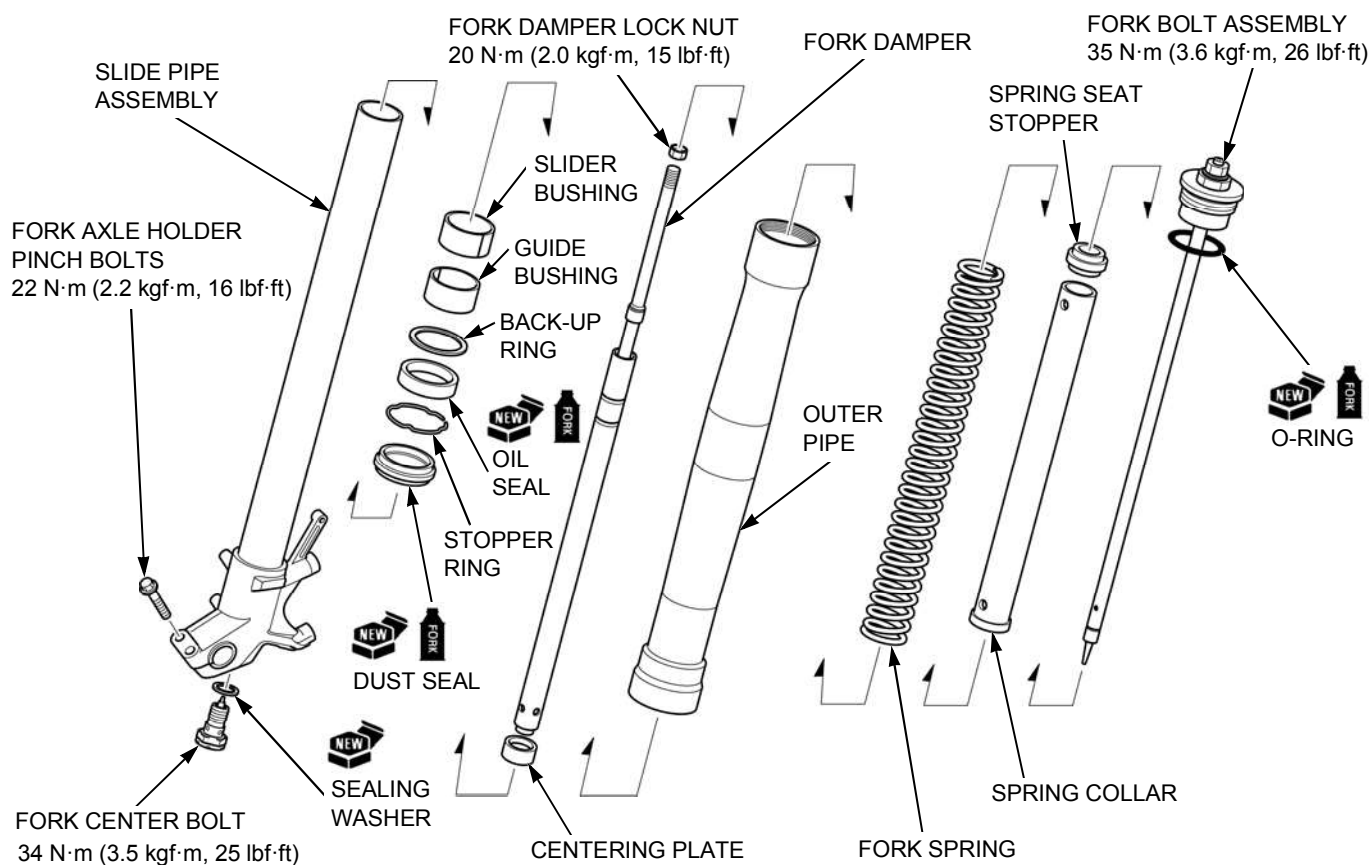

- Before assembly, wash all parts with a high flash point or non-flammable solvent and blow them dry.
- When installing the fork dust seal and oil seal, wrap the edge and groove of the slide pipe with tape [1].

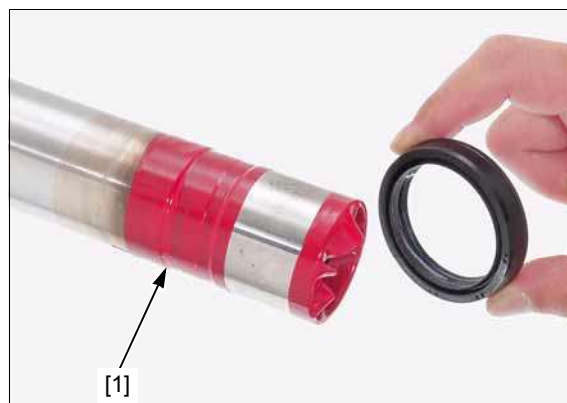



Apply fork fluid to new dust seal and oil seal lips.

*Install the oil seal with its marked side facing toward the axle holder.*

Install the dust seal [1], stopper ring [2] and oil seal [3].

Install the back-up ring [4], guide bushing [5].

Install the slider bushing [6] if it is removed.

## NOTE:

- Remove any burrs from the bushing mating surface, being careful not to peel off the coating.
- Do not open the slider bushing slit more than necessary.

Install the slide pipe assembly [7] into the outer pipe [8].

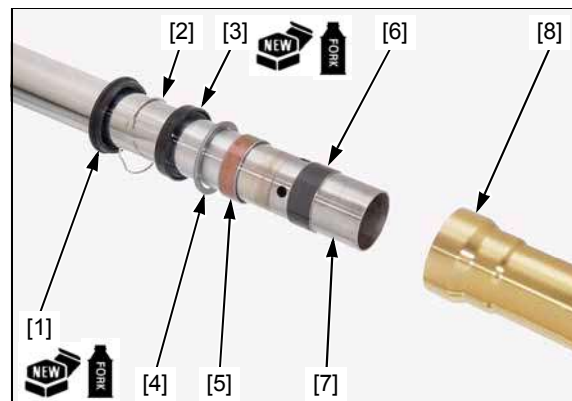

Put the guide bushing [1], back-up ring [2] and oil seal [3] on the outer pipe.

Put the special tool on the oil seal.

## TOOL:

**Fork seal driver, 45.2 mm [4] 07KMD-KZ30100**

*See illustration for correct seating.*

Drive the oil seal with the guide bushing and back-up ring into the outer pipe until the stopper ring groove [5] is visible using the special tools.

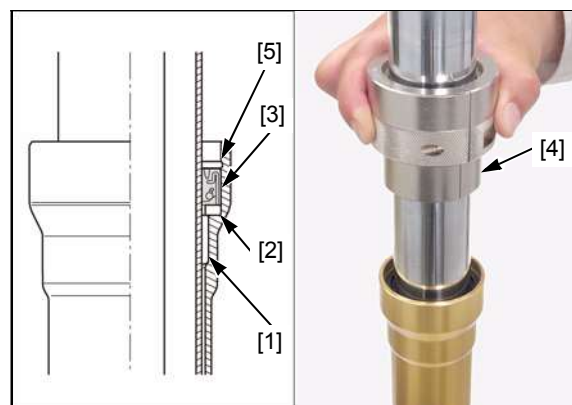

*Do not scratch the fork pipe sliding surface.*

Install the stopper ring [1] into the groove securely.

Install the dust seal [2].



Install the fork damper assembly [1] and centering plate [2].

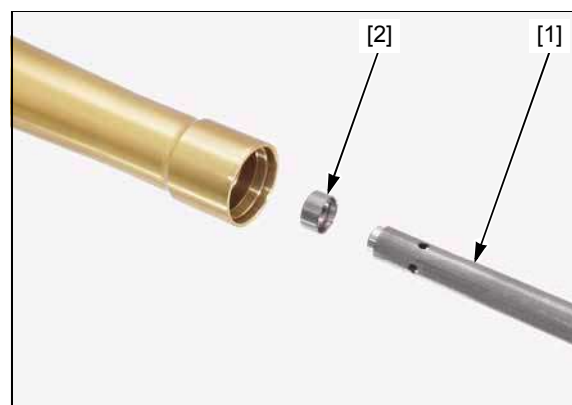

## FRONT WHEEL/SUSPENSION/STEERING

Install the socket bolt [1] with a new sealing washer [2].  
Hold the axle holder in a vise with soft jaws or a shop towel.

Tighten the center bolt to the specified torque.

**TORQUE: 34 N·m (3.5 kgf·m, 25 lbf·ft)**

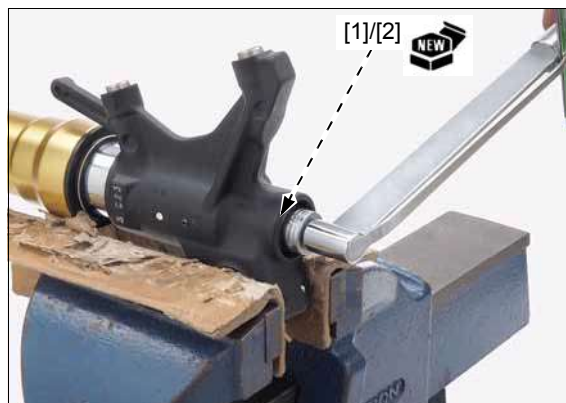

Pour the specified amount of recommended fork fluid.

### RECOMMENDED FORK FLUID:

**Honda Ultra Cushion Oil 10W (SS-47)**

### FORK FLUID CAPACITY:

**721 ± 2.5 cm<sup>3</sup> (24.4 ± 0.1 US oz, 25.4 ± 0.1 Imp oz)**

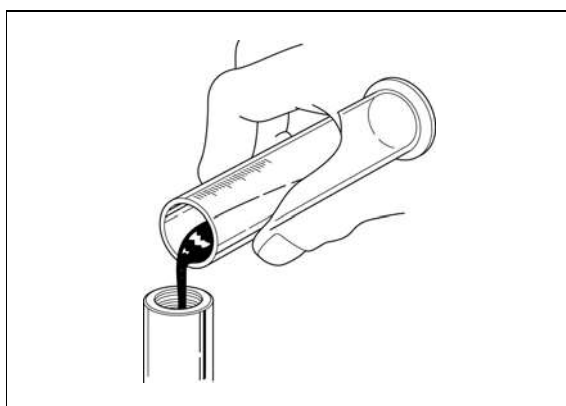

Bleed the air from the fork as follows:

1. Extend the fork, cover the top of the outer pipe [1] with your hand and compress the fork slowly.
2. Remove your hand and extend the fork slowly.  
Repeat above procedure 2 or 3 times.
3. Install the special tool to the fork damper rod [2].

### TOOL:

**Damper rod holder [3]      070MF-MBZC120**

Pump the fork damper rod slowly 8 – 10 times.

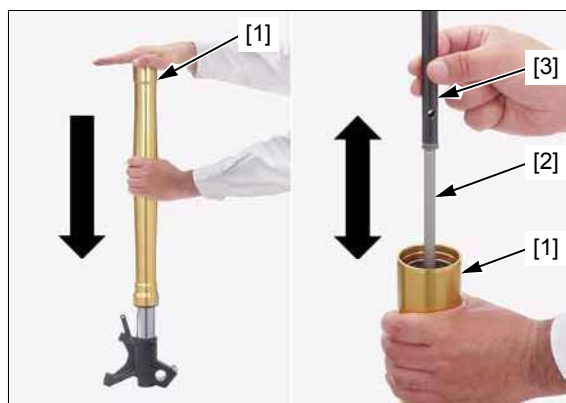

Slowly push the outer pipe [1], and gently seat the dust seal [2] onto the axle holder [3] and leave it for 5 minutes.

*Be sure the oil level  
is the same in the  
both forks.*

After the oil level stabilizes, measure the oil level from the top of the outer pipe.

### FORK FLUID LEVEL:

**95.0 mm (3.74 in)**

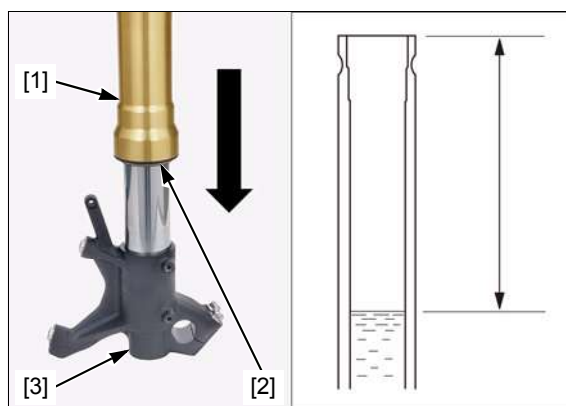

Install the fork spring [1] into the slide pipe assembly with the tightly wound side facing down.

Install the spring collar [2] and spring seat stopper [3].

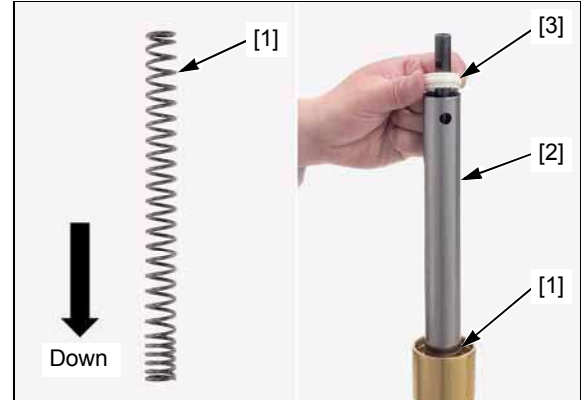

Clench the lock nut [1] until it is fully seated.

Attach the special tool to the spring collar holes [2].

**TOOL:**

**Spring collar holder [3] 070MF-MBZC110**

While pulling the damper rod holder [4] up, compress the spring collar [5] with the special tool.

Insert the special tool between the lock nut and spring seat stopper [6].

**TOOL:**

**Stopper plate [7] 070MF-MBZC130**

Remove the damper rod holder.

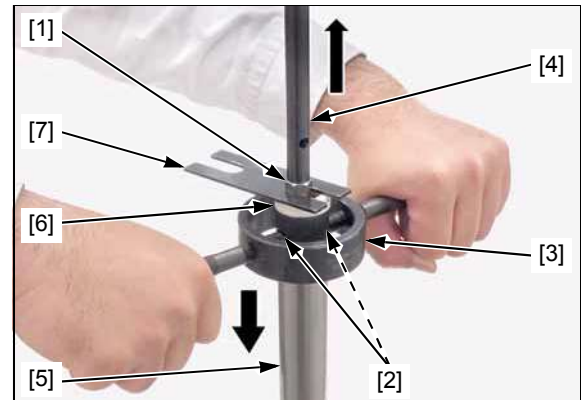

When installing the fork bolt assembly [1], turn the rebound adjuster [2] counterclockwise to the softest position.

Apply fork fluid to a new O-ring [3] and install it to the fork bolt assembly.

Install the fork bolt assembly to the fork damper until it is fully seated.



*Be careful not to damage the fork bolt when tightening it.*

Tighten the fork bolt to the specified torque while holding the lock nut [1].

**TORQUE: 20 N·m (2.0 kgf·m, 15 lbf·ft)**

Remove the stopper plate [2] and spring collar holder [3].

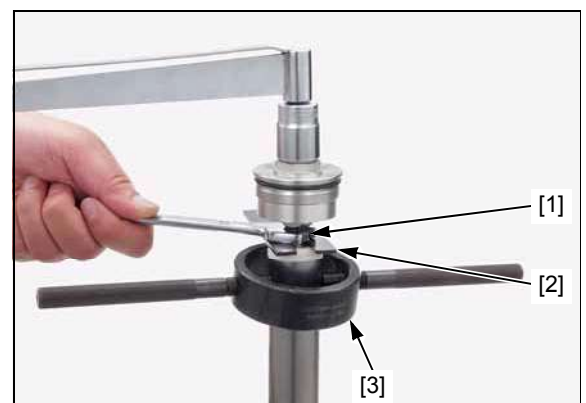



## FRONT WHEEL/SUSPENSION/STEERING

*Tighten the fork bolt after installing the fork slider into the steering stem.*

Install the fork bolt [1].



### INSTALLATION

Install the forks through the bottom bridge and top bridge so that the end of the outer pipe [1] is aligned with the top bridge [2] upper surface.

Tighten the bottom bridge pinch bolts [3] to the specified torque.

**TORQUE: 25 N·m (2.5 kgf·m, 18 lbf·ft)**

*Be careful not to damage the fork bolt when tightening it.*

If the fork bolt [4] is loosened, tighten it to the specified torque.

**TORQUE: 35 N·m (3.6 kgf·m, 26 lbf·ft)**

Tighten the top bridge pinch bolts [5] to the specified torque.

**TORQUE: 22 N·m (2.2 kgf·m, 16 lbf·ft)**

Return the pre-load and rebound damping adjusters to the original positions as noted during disassembly.

- Front speed sensor (CRF1000A/D) (page 20-20)
- Front wheel (page 17-14)
- Front fender (page 2-9)

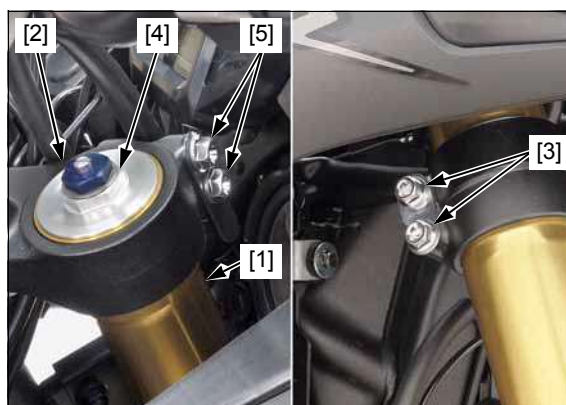

## STEERING STEM

### REMOVAL

Remove the air cleaner case (page 7-11).

Remove the handlebar lower holder (page 17-7).

Disconnect the immobilizer receiver 4P (Black) [1] and ignition switch 2P (Brown) [2] connectors.

